

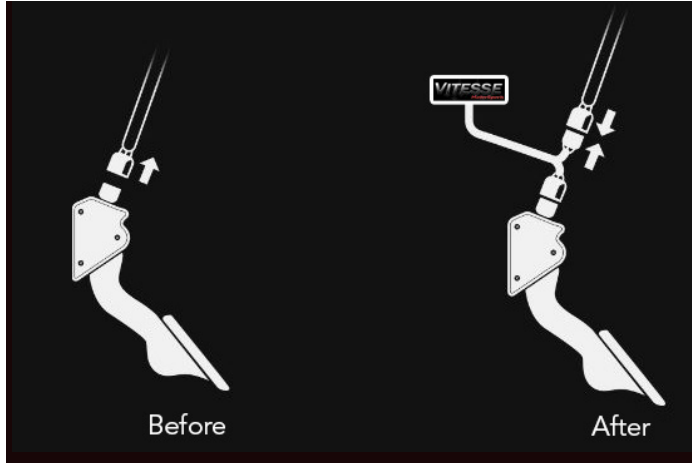

## THROTTLE CONTROLLER Install / Calibration

### Instructions on how to install:



- Unplug the wire from the gas pedal at the connector.
- Connect our Throttle Controller as shown.
- Mount the main box somewhere under the dash using the double sided tape.
- The wired remote can be disconnected to make it easier to be placed anywhere you like.

Make sure the engine is off and your transmission the Parking position or Neutral for manual cars.

Push your driver seat all the way to the back to give you enough room to access under the dashboard.

Unplug the Harness that is connected to your Gas Pedal (First you will need to push up the securing safety pin, after that pull the harness upward by holding the plastic connection, not the wires!)

Now you can plug the harness that comes with the controller, male to female and female to the Gas pedal harness.

Please make sure it is plugged all the way in until you hear a click sound.

The optional yellow and blue wires on the main unit will not be used now. (Brakes / Launch Control option)

### Instructions on how to setup the Controller:

Make sure all the cables / harnesses are perfectly connected.

**Step 1:** Press or turn the key to ACC or RUN Position, (without starting your engine). In some cars you simply push and hold the Start button for a few seconds without touching the brake pedal for a few seconds.

After you see all the lights on your dashboard. Press and Hold the Knob on your new Controller, You should see a countdown: 3 – 2 – 1 – 0 After you see the “zero” on the remote display, you can release the knob.

**Step 2:** When the display shows you L (Low Voltage) it's the voltage value of your gas pedal when it is at rest, do not push the gas pedal yet. You need to push the knob one click and release, the display will show “SET” and then H ( High Voltage Value ).

**Step 3:** When your display shows H ( Voltage Value at rest ), now you push the gas pedal to the bottom and hold it to the floor, do not release yet. The High Voltage Value with gas pedal pushed to the max will show, now you press again one click and release the Knob. Keep your foot on the gas pedal until you see on the display “100”, now you can release the gas pedal.

**Step 4:** Turn off ACC, then take out the key. You're all finished with the Calibration! Your new controller is now Ready.

### How to use our Throttle Controller:

Pushing the Knob once will toggle between the SP ( Sport mode ) and Ec ( Economy mode ).

SP0 being stock going all the way to SP9 being the highest setting.

The Economy mode decreases the Throttle response ( It opens the Throttle Body blade in a way to help you save Gas. EC7 being the most economical setting.

For any assistance or questions, please email us at: [sales@vitesse-motorsports.com](mailto:sales@vitesse-motorsports.com) or call (201) 708-7017

[www.vitesse-motorsports.com](http://www.vitesse-motorsports.com)